

Michigan State University
 Founded 1855

On this site stood College Hall, the first building in the United States erected for the teaching of scientific agriculture. Here began the first college of its kind in America, and the model for Land-Grant colleges established under the Morrill Act of 1862. This act granted lands for the endowment of colleges to provide for "liberal and practical pursuits and professions in life."

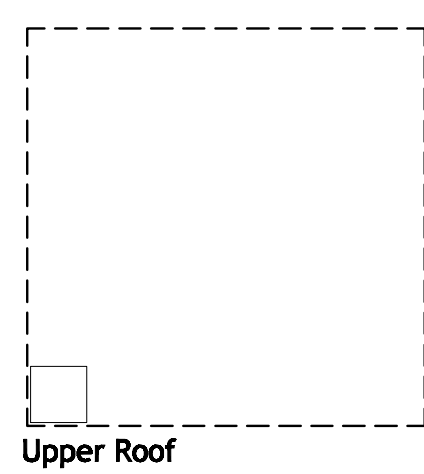

- Heavy dashed line = CUT
- - - Broken line = FOLD
- ⋯ Dotted line = CUT SLOT

Assembly:
 Cut on the heavy dashed lines. Fold on the broken lines. Cut slots (marked with lower case letters) for corresponding tabs (marked with upper case letters). Attach Octagonal West Bay to Tower Base with tabs A & B. Tape or glue Tower Base and Upper Tower on tabs marked with a ☆. Attach Upper Tower to Tower Base using tabs C-F. Glue or tape Upper Roof and Northeast Spire to complete.



east arbor
architecture

Daniel E. Bollman, AIA

daniel@eastarbor.com
 511 Bailey
 East Lansing, MI 48823
 517.993.8148

Save for later use